

## OPERATION MANUAL OF COFFEE GRINDER

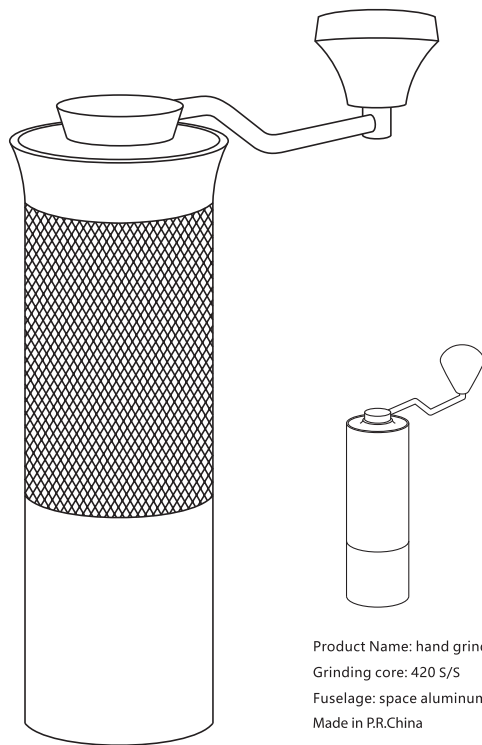

## PRODUCT MIX

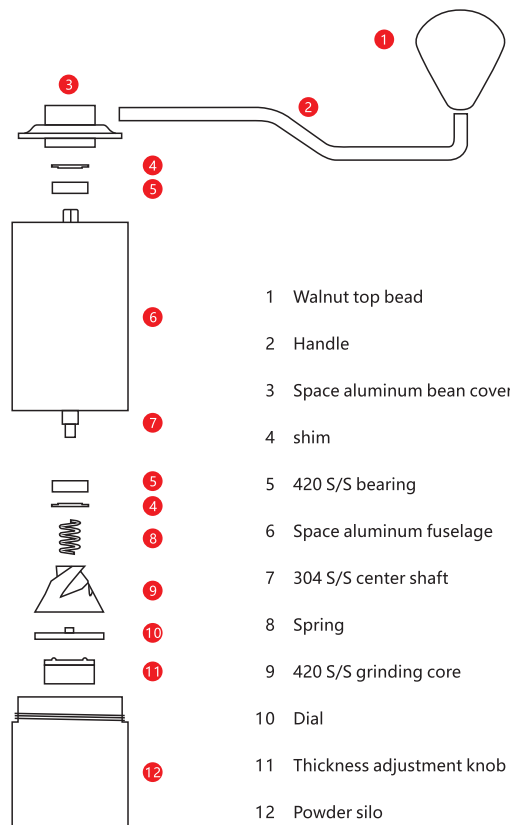

## ADJUSTMENT

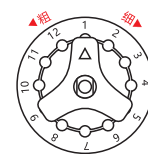

Counterclockwise  
rotation thickening  
Clockwise rotation  
for thinning

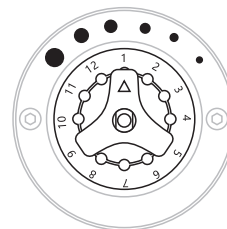

**11 Thickness adjustment knob**  
(the larger the number, the thicker the number, the smaller the number, the finer)

### Origin STEP1

Take out the powder bowl, and the knob is located under the main body. Turn the knob clockwise to the tightest position, taking this as the origin. Cover and hold the handle when turning the knob. Do not turn the handle after the knob is turned to the original point to avoid damaging the grinding core.

### STEP2

Start with the origin, turn the knob counterclockwise, and the coffee powder adjustment becomes thicker.

### STEP3

The reference of coffee powder used in different appliances is as follows.

### From the origin

Espresso turn 7-10  
Make coffee by hand turn 16-21  
French pressure turn 21-23

Note: 1. The above adjustment values are for reference only.  
2. The scale numbers are only reference values.

## CLEANING METHOD

### ◆ Routine cleaning

There is no need to disassemble. Use a soft brush to clean the residual powder after each use.

### ◆ Deep cleaning

Remove the outer disc, take out the parts in turn, clean it with a brush and a balloon, and then wipe it with a dry towel.

### ◆ Be careful:

1. The inside of the grinder is a precision structure, which can be deeply cleaned after 3-6 months of normal use. Frequent disassembly may affect the grinding effect.
2. This machine is equipped with precision parts, please do not wash with water.

## GRINDING METHOD

